



***SRCAMV6.5 Super Cam  
20 M Wireless Inspection Camera***

***THE SMARTER WAY TO INSPECT***

<b>Contents</b> .....	3
<b>Start-up guide</b> .....	4
<b>Super Cam features</b> .....	5
<b>Super Cam App</b> .....	6
- Buttons Configuration .....	6
- Manual/Auto Focus .....	6
- Brightness .....	6
- Pinch Zoom .....	6
- Saving Pictures/Videos .....	7
- Settings .....	8
- Icon Options .....	9
<b>Charging the Super Cam</b> .....	10
<b>Connecting the Super Cam to multiple devices</b> .....	11
<b>Specifications</b> .....	12
<b>Warranty</b> .....	13
<b>FAQs</b> .....	14

## CONTENTS:

- 1 Carry Case
- 2 Type C Charging Cable
- 3 Super Cam Wireless Inspection Camera
- 4 Super Rod Flexi
- 5 Super Rod Gooseneck
- 6 Super Rod Tuff Hook
- 7 Adaptors
- 8 Male Gender Changer
- 9 Super Magnet
- 10 1m Telescopic Stick



**DOWNLOAD THE SUPER CAM APP:** Scan the QR Code to get the App or search for Super Rod



Requires Android  
V6.0 or later



Requires IOS  
V11.2 or later



Apple, the App Store and the Apple Logo are trademarks of Apple Inc., registered in the U.S. and other countries. Google Play and the Google Play logo are trademarks of Google LLC

On first use you need to give the App access to the gallery of photos and videos on your device to be able to allow you to save photos and videos.

**CONNECT TO YOUR SUPER CAM CAMERA:** First unscrew the red cap at the back of the camera. Turn the power switch on. Once on, the dot should be green.



Ensure the camera is charged, the on button has been pushed to the right and that the green light is on.

Turn on WiFi connection in your Settings on Apple devices or Connections on your Android devices

Click on WiFi and search for "Super Cam xxxxxx" on the WiFi list (no other WiFi network is needed)

# SUPER CAM FEATURES

Connect the Super Cam to any smart device and capture data. Work safer and smarter by streaming high resolution video to your smart device in real time.

- Speed up visual inspections
- Accurate inspection reports/quotations
- Easier fault finding
- Safe working in hard-to-reach places
- Time-saving cable installation

## • INSPECT • ROUTE • CAPTURE DATA • WORK SAFE

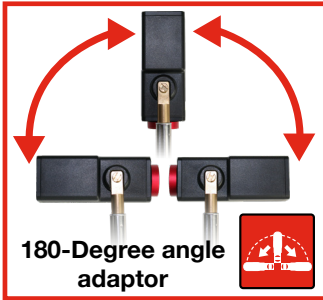

**CONNECT TO YOUR SMART PHONE OR TABLET**



**Wireless range up to 20m**  
- In line of sight



**Always up viewing mode**  
- When the camera rotates, the image stays the right way up (when selected in settings)



**60 min fast charge**  
- Fully charged in 1h with Type-C USB quick charge



**Auto/manual focus**  
- Long press icon for manual adjustments



**Non-contact voltage detector**  
- Audio & visual alert, 50V-1000V AC



**IP67 dustproof and waterproof**  
- Only when back cap is securely fastened



**Built-in WiFi hotspot**  
- Provides a high resolution live stream up to a 20m range



**Record video with sound**  
- Accurate inspection reports for your customers



**Digital pinch zoom**  
- Increases visibility and precision on inspections

## BUTTON CONFIGURATION



Battery Level Indicator



Capture Photos



Capture Videos



Content Gallery



Adjust Brightness



Manual/Auto Focus



Help



Settings



Icon Layout Settings

## AUTO/MANUAL FOCUS



Tap the AF/MF icon on your Super Cam app to adjust the focus. Alternatively, long press on the AF/MF icon and adjust the focus with a slider for detailed close-up viewing.

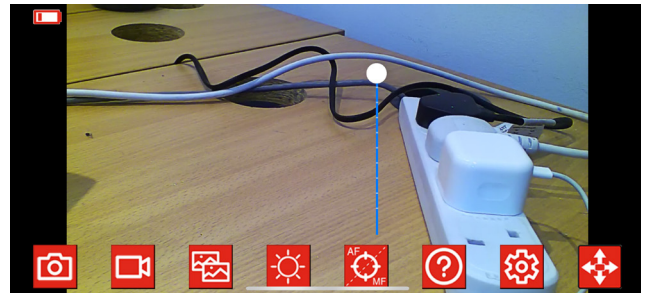

## BRIGHTNESS

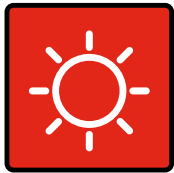

Tap the Brightness icon on your Super Cam app to adjust the lighting. Alternatively, long press on the icon and adjust the brightness up or down with a slider.

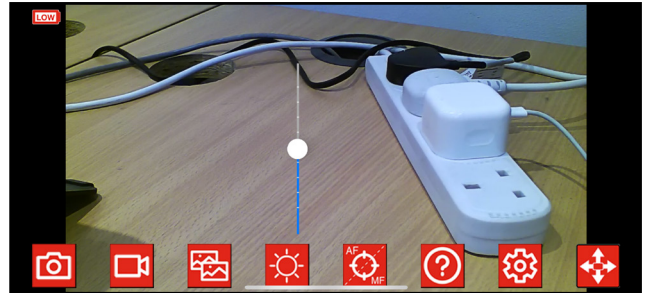

## PINCH ZOOM



Use 2 fingers to use the digital zoom to bring your image closer.



## SAVING PICTURES/VIDEOS



Tap the Camera icon to take a picture.

Once you have taken a picture you can either save it or delete it and start again if you decide you want to take a different one. If saved, the picture will be stored in both your Super Cam app photo gallery and the camera roll from the device you are using.



Tap the Video icon to take a video

The video will be saved in your Super Cam app video gallery automatically as well as the camera roll from the device you are using.

### Photo Gallery



Tap on the Photo Gallery icon to access all images taken with your Super Cam.

To view an image, tap on it.

To delete an image press 'select' and tap on the image(s) you want to select then press delete.

### Video Gallery



Tap on the Video Gallery icon to access all footage taken with your Super Cam.

To view a video, tap on it.

To delete a video press 'select' and tap on the video(s) you want to select then press delete.

## WIN!

For a chance to receive a gift send us your best footage and images captured using the Super Cam. If your content is shared then we will send you a gift. Any content you sent us can be used for marketing purposes. Send your content to [sales@super-rod.co.uk](mailto:sales@super-rod.co.uk)

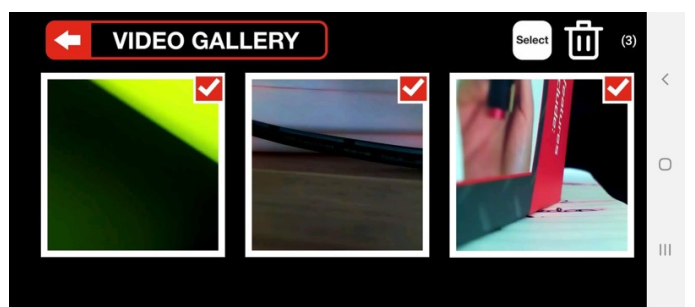
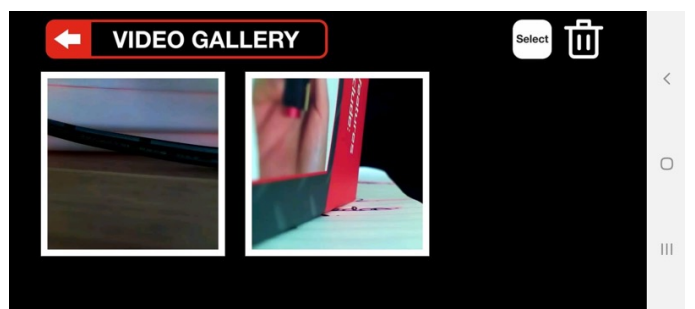
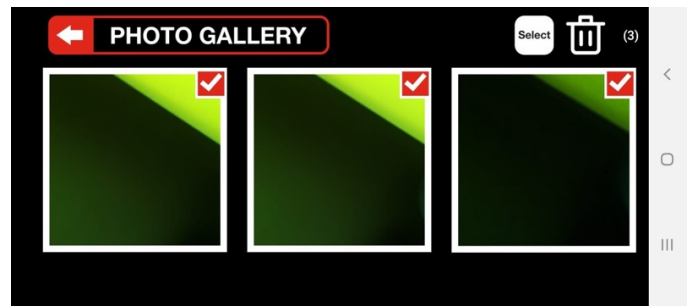
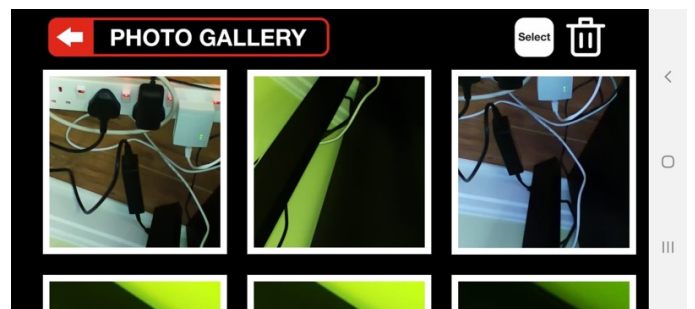
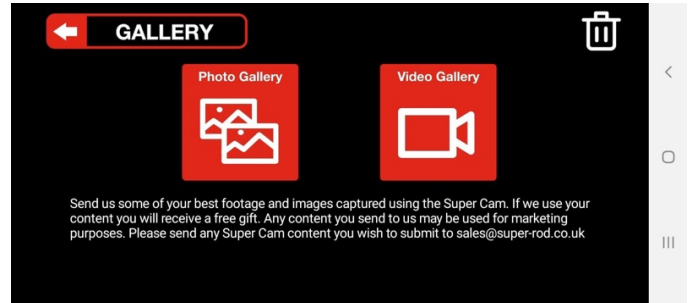
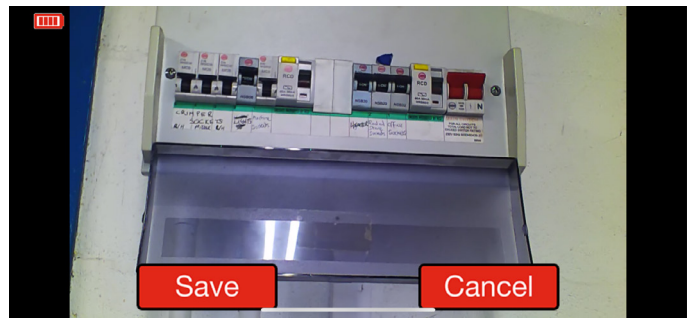

## SETTINGS



The Settings screen allows you to do the following: Change the Display Mode from Standard to Always up Round or Full Screen.

- Standard Mode: the image on the screen rotates as the camera rotates
- Always up Mode (either Round or Full Screen): the image on the screen remains the right way up on the app display, regardless of the camera's orientation

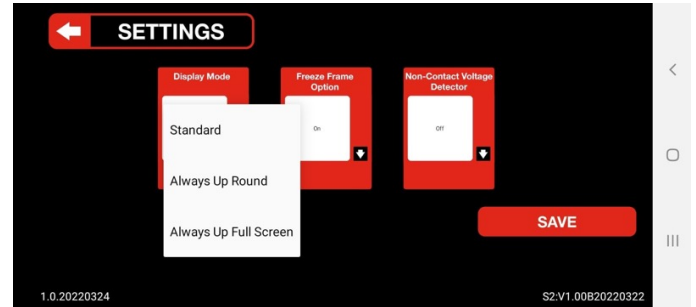

Change the Freeze Frame option

- On: this will allow you to have a choice to save the image or not when taking a picture
- Off: the image you have taken will save automatically

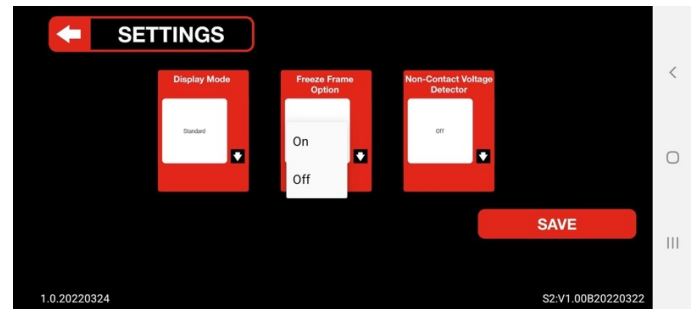

Change the settings for the Non-Contact Voltage Detector

- Off: The Voltage detector is deactivated
- Visual Only: Red light around the image on our Super Cam app

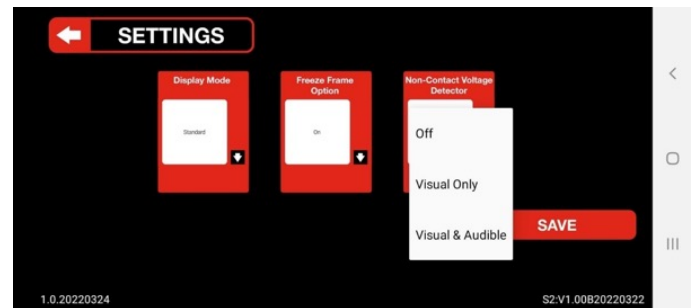

- Visual & Audible: Red light around the image on your Super Cam app as well as a beeping sound

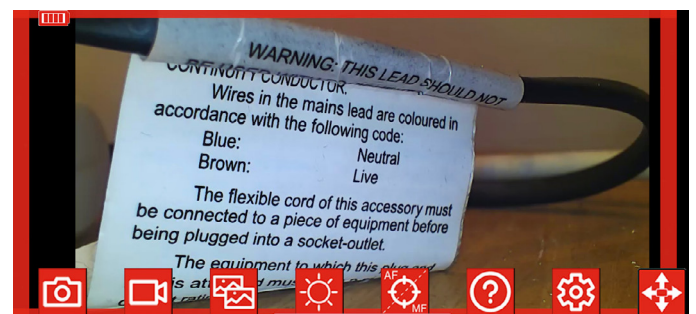

Make sure you save once you have changed the setting.

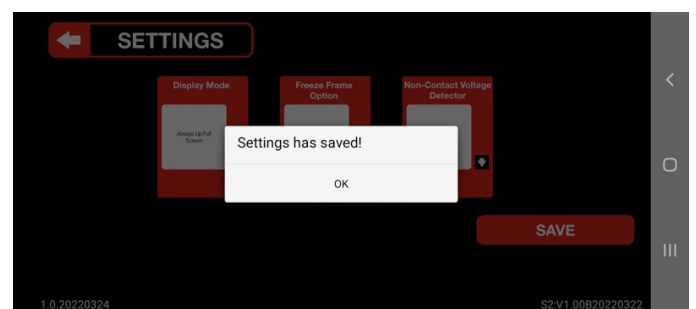



## ICON OPTIONS



Press long on the Icon Options icon to choose the position of the icons

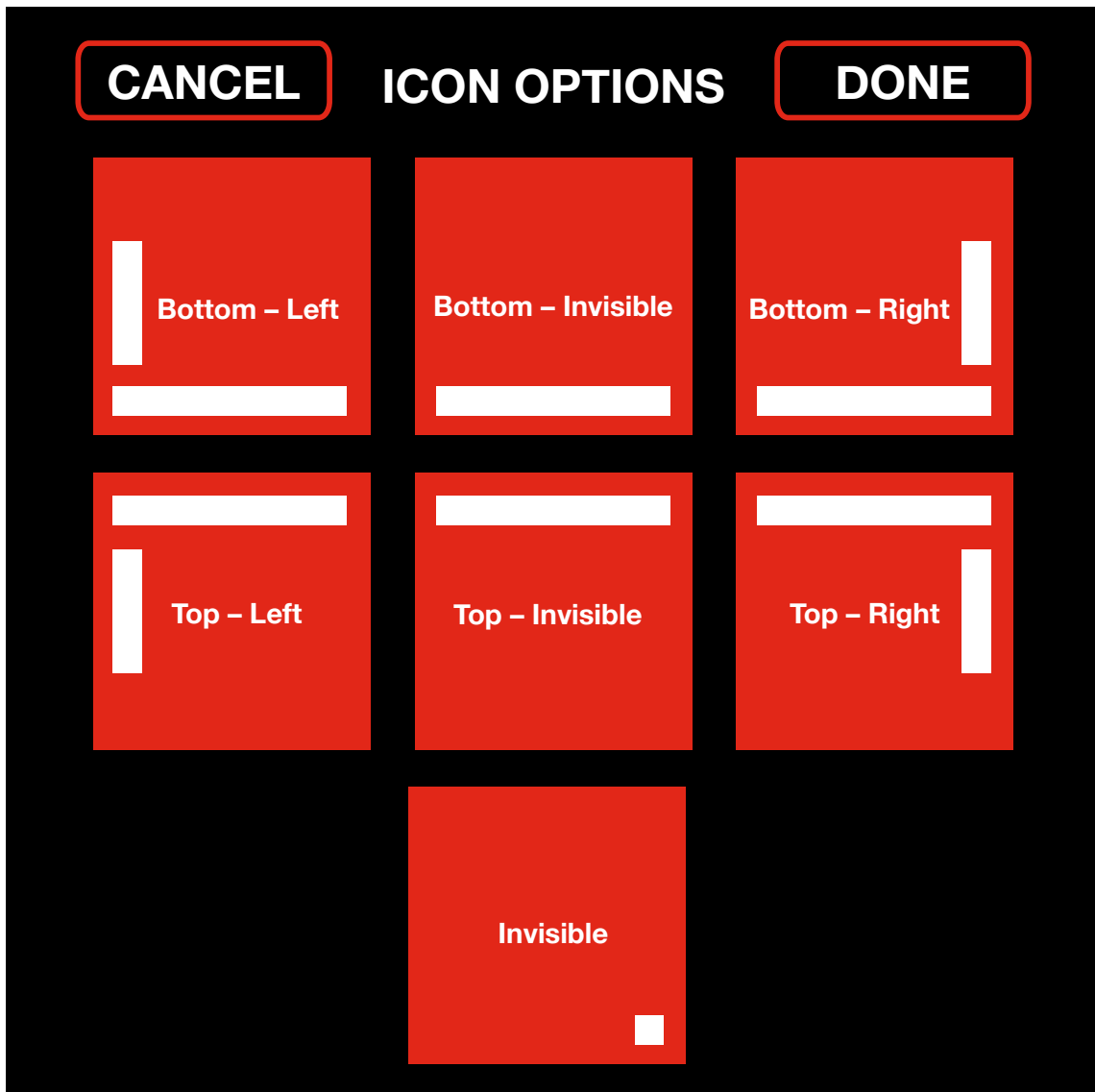

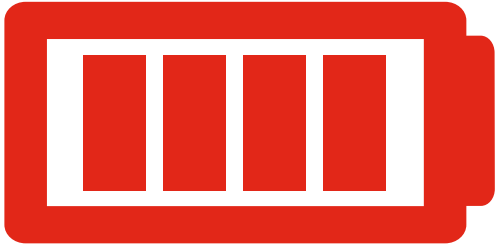

A Type-C USB Charging Cable is included in the Super Cam kit. The Super Cam features a fast-charge allowing you to charge it fully in an hour.



**Green light when in use.**



**Red light when it's charging**

The charge is indicated on the top left of your screen while using the app



**Blue light when it's fully charged**

## CONNECTING THE SUPER CAM TO MULTIPLE DEVICES

Connect your Super Cam wirelessly to multiple devices at the same time allowing users not in same location to use the same Super Cam. Users will be able to view the same thing and control the features directly on their device.

To connect multiple devices to the Super Cam:

Turn on WiFi connection in your Settings on Apple devices or Connections on your Android devices  
Click on WiFi and search for “Super Cam xxxxxx” on the WiFi list (no other WiFi network is needed)

Note: There is no limit of numbers of devices connected to the same camera, but the more devices connected the higher latency. For better users' experience two devices is recommended.

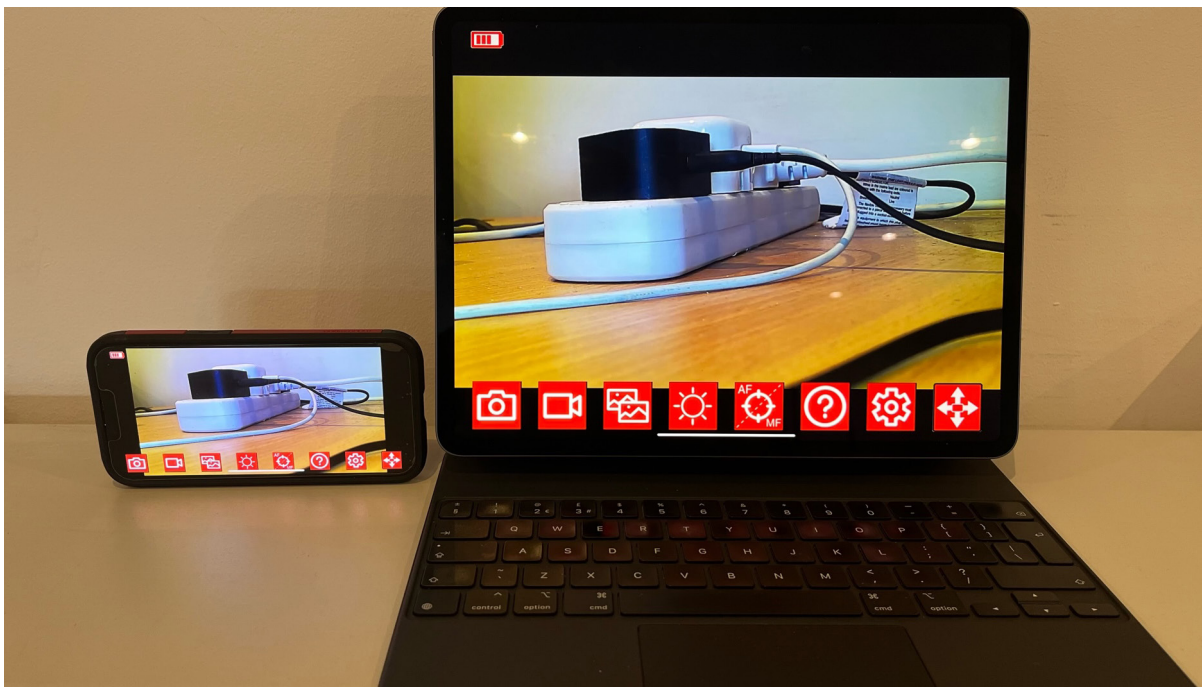

<b>SRCAMV6.5 - Super Cam Wireless Inspection Camera Specifications</b>	
Wireless Range	up to 20m
Frequency	2.4GHz WIFI
Camera Resolution	720p (1280 x 720) for both live and recorded videos
Operating Time	approx 90 mins (LEDs full) to 105 mins (LEDs off)
Charging Time	60 min fast charge
Viewing Angle	33 Degrees (Horizontal)
Charge Port	USB Type C
Battery Capacity	650mAh
Battery Type	lithium polymer
Operating Temperature	0 degrees to 35 degrees Celsius
Storage Temperature	-20 degrees to 45 Degrees Celsius
Charge Voltage	5V DC
Non-Contact Voltage Detector Sensitivity	best sensitivity 150 voltage AC and above - CATIII 600V
Non-Contact Voltage Detector Sensor Range	50V-1000V AC (Approx)
Adjustable bright white LEDs	6 white - control functionality via the app (off, 25%, half, full)
IP67	dustproof and waterproof with back cap on
Built in right angle adaptor	180 degrees

## WARRANTY

The Super Cam warranty covers defects in materials and workmanship for a period of 2 years after date of original retail purchase.

At its option, Super Rod will repair or replace, any product which fails to conform to this warranty. This warranty does not apply to damage from alterations, abuse, misuse, lack of maintenance, or normal wear and tear of the product.

This warranty explicitly does NOT cover cut or deliberately damaged tape, rust or corrosion or foreign material, cracked or broken cases, or bent hooks or bent/missing accessories.

Please email [sales@super-rod.co.uk](mailto:sales@super-rod.co.uk), or simply return your Super Cam your place of purchase with proof of purchase.

### Important Information – Li-Ion Batteries

The Super Cam camera contains a Li-Ion battery. For optimal battery life, do not store the camera while the battery is flat, do not store the camera in temperatures of over 35°C (95°F) and if the camera is not being used, top up the charge every 6 months.

### **I can't connect or see the camera when I search on Bluetooth?**

The Super Cam has a built-in WiFi hotspot. No other network is needed, and the camera does not connect via Bluetooth. Refer to the start-up guide on page X to connect the Super Cam to your device.

### **Can I use the camera underground, underwater or inside a conduit?**

The Super Cam is IP67 dustproof and waterproof only when back cap is securely fastened. However the Super Cam will not work underground, underwater or inside a metallic conduit as the WiFi signal will be blocked.

### **How long does the battery last?**

The Super Cam will give you up to 90 minutes of use, with the LEDs on full brightness and 105 minutes of use with the LEDs off, before it needs recharging.

### **What does the rear LED indicate?**

Green light when in use.

Red light when it's charging

Blue light when it's fully charged.

Refer to page X for more information.

### **I don't use Super Rods can i use the Super Cam with other cable rods on the market?**

Yes the Super Cam comes with two Cable Rod Adaptors that has M4 & M5 threads, these can be used with the Super Cam to fit most Cable Rods sold in the UK & Europe.

### **My Super Cam does not reach a wireless distance of 20m.**

The 20m wireless range is an indication of the distance in line of sight and does not take into account any obstructions.

### **I can connect to the WiFi, but it won't show an image in the iOS App? It shows an error message Error(100)(Connect the device time out!)**

Go to Settings-> Mobile Data-> Scroll down to find the Super Cam App and turn off to prevent the App trying to use mobile data.

### **I can connect to the WiFi, but it won't show an image in the Android App? It shows an error message Error(100)(Connect the device time out!)**

Go to Settings-> Connections-> Data Usage-> Mobile Data only apps-> Scroll down to find the Super Cam App. Turn off background data to prevent the App trying to use mobile data.